

TRUCK CAMPER

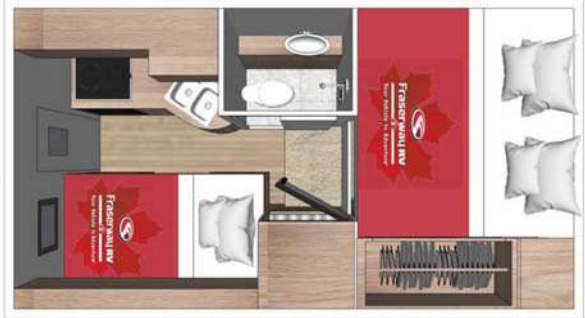

Click to visit our website for more multimedia and vehicle details.

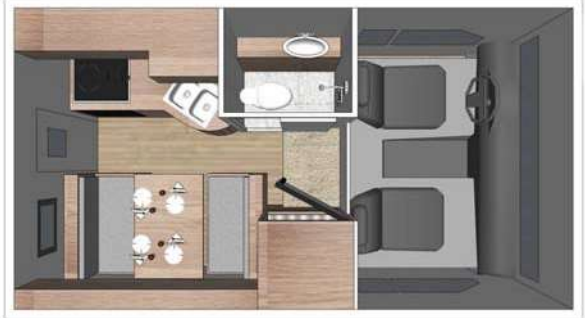

Passenger Capacity	
Sleeping capacity	2 adult and 1 child
Recommended for	2 adults
Seat belts	5
Rear 3-point seat belt	Yes
Child seat option	Yes

Vehicle Specifications	
Chassis make	Ford F350
In-service date ¹	2020-2022
Fuel type	Diesel
Fuel consumption	14-20 liter per 100 km
Engine size	V8
Auto transmission	Yes
4x4	Yes
Cruise control	Yes
Navigation system	Yes
Dashboard A/C	Yes
Dual battery	Yes
Battery boost switch	No
Backup camera	Yes

Media Compatibility ²	
CD-player	No
Auxiliary plug-in	No
USB-stick	Yes
iPhone via USB	Yes
Android via USB	No
Bluetooth	Yes

RV Features	
Fridge and freezer	Yes
Stove	Yes
Oven	Propane
Microwave	No
Furnace	Yes
Roof A/C	No
Hot water heater	Yes
Flush toilet	Yes
Shower	Yes
Generator	No
Solar panel	Yes
Awning	Yes

Sleeping Specifications	
Over-cab bed	150 x 197 cm 59" x 77"
Dinette bed	80 x 183 cm 31" x 72"
Rear bed	Not applicable
Other bed	Not applicable
Safety net in over-cab bed	No

Tank Capacities	
Fuel tank	98-128 liter
Fresh water	95-122 liter
Black water	50-65 liter
Grey water	72-115 liter
Propane	32 liter

Vehicle Dimensions	
Exterior length	704 - 750 cm 23'1" - 24'7"
Exterior width	250 cm 8'2"
Exterior width with slide-out extended	Not Applicable
Exterior height	389 cm 13'1"
Interior height	195 cm 6'4"

Seat Belt Configuration	
Rear bench in pick up truck	2 three-point seatbelts with tether hooks for up to 2 infant, child or booster seats

¹ The in-service date of a vehicle is the date on which the very first customer drove the vehicle off the Fraserway lot.

² Fraserway does not guarantee compatibility with any media device.

All specifications and measurements are approximate and subject to change.

